

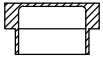

TYLER
MUELLER
BIBBY-STE-CROIX

NO. 6860
NO. H-10361
NO. B-5160

7.5' MINIMUM COVER REQUIRED OVER
TOP OF WATER MAIN.



DROP LID

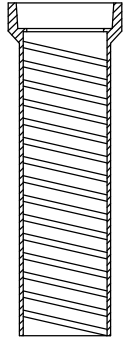

TOP

TYLER	NO. 6860	26"
MUELLER	NO. H-10361	26"
BIBBY-STE-CROIX	NO. VB502	27"

GRADE

ADJUST TOP TO 0.25" TO 0.5"
BELOW GRADE. BOX TO BE SET
TO PROVIDE 12" OF ADJUSTMENT.

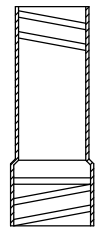

EXTENSION

TYLER	NO. 58	14"
	NO. 59	18"
	NO. 60	24"
MUELLER	NO. 58	14"
	NO. 59	20"
BIBBY-STE-CROIX		
VB520	NO. 57	9"
VB521	NO. 58	14"
VB522	NO. 59	20"
VB523	NO. 60	26"

TYLER NO. 6860 MUELLER NO.
H-10357 BIBBY-STE-CROIX
B-5001 GATE VALVE BOX, SCREW
TYPE, 3 PIECE, 5 1/4" SHAFT,
SIZE G BOX, 7'-6" EXTENDED,
#6 ROUND BASE.
DO NOT INSTALL RISER ROD.

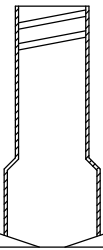

BOTTOM

TYLER	NO. 6860	65"
MUELLER	NO. H-10361	65"
BIBBY-STE-CROIX	NO. VB516	60"

GATE VALVE ADAPTER: 1/4" STEEL
WITH PROTECTIVE COATING,
1/2" RUBBER GASKET INSTALLED
BETWEEN THE GATE VALVE AND
GATE VALVE ADAPTER.

CLOW, MUELLER OR
APPROVED EQUAL
RESILIENT WEDGE VALVE
CONFORMING TO AWWA
C-509 STANDARDS WITH
STAINLESS STEEL NUTS
AND BOLTS AND 2"
BRONZE OPERATING NUT.

VALVE AND BOX TO BE
PLASTIC WRAPPED PER
SECTION 2.03A

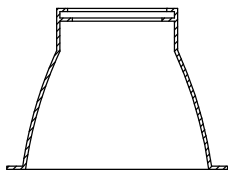

BASE

8"x8"x16" CONCRETE BLOCK

TYPICAL GATE VALVE AND BOX INSTALLATION



REVISED: 2-24

ENGINEERING DEPARTMENT

PLATE NO.:

1006