

- T112-0882 HARDWARE PACKAGE INCLUDES:  
 (4) 1"x4" GALV. CARRIAGE BOLTS FULL THREADS.  
 (4) ROUND FLAT WASHERS.  
 (5) 1" NUTS.  
 (4) LOCK WASHERS. &  
 (4) 3"x 3"x1/4" TAPPED RETAINING WASHER.

8.75" TO 17" DIA.  
BOLT CIRCLE

(4) NOTCHES IN SHAFT  
TO ALLOW BOLT HEAD  
CLEARANCE

**NOTES**

1. FINISH, HOT DIP GALVANIZE PER ASTM-A155 (LATEST REVISION).
2. BASEPLATE TO BE PERPENDICULAR TO SHAFT AXIS (& 1" AND HOLE CENTERLINE CONCENTRIC (4.185) TO SHAFT AXIS.
3. STENCIL MIN 1/2 IN. LETTERS MANUFACTURER'S NUMBER AFTER GALVANIZING.
4. PILOT POINT AND SHAFT AXES TO BE CONCENTRIC (+/- .125 F/H) AND IN LINE (+/- 2').
5. PLANE CUT SLOT PERPENDICULAR TO THE BASEPLATE.
6. PREHEAT, TUMBLEBLAST, HANDGRIND, AND CLEAN BASEPLATE HELIX AND PILOT POINT ON ALL WELDED AREAS.
7. FLAMECUT IRREGULARITIES PERMISSIBLE. (1) VALLEYS NOT TO EXCEED 3/32" BELOW NOMINAL SURFACE LEVEL. (2) PEAKS OR POSITIVE IRREGULARITIES NOT TO EXCEED 1/32" ABOVE NOMINAL SURFACE LEVEL OR INTERSECTIONS OF NOMINAL SURFACES.
8. ALL MATERIAL IS TO BE NEW, UNUSED AND MILL TRACEABLE MEETING THE FOLLOWING SPECIFICATIONS:

**BASEPLATE:** ASTM A28-(LATEST REVISION) STRUCTURAL STEEL (CONFORM TO AASHTO TECH. BUL. 1270.)

**SHAFT:** ASTM: A252-(LATEST REVISION) GRADE 2. STEEL PIPE PILES. ALTERNATE MATERIAL: ASTM A53-(LATEST REVISION) TYPE E OR B, GRADE B. STEEL PIPE OR ASTM A500-(LATEST REVISION) GRADE B STRUCTURAL STEEL TUBING.

**HELIX:** ASTM A636-(LATEST REVISION) HOT ROLLED STEEL.

**PILOT POINT:** ASTM A575-(LATEST REVISION) STEEL BAR.

**BOLTS:** CARR BOLT PER ANSI B10.8.1, 845 JAES GRADE-5.

10. BASEPLATE IS PERMANENTLY STAMPED WITH MANUFACTURER'S IDENTIFICATION "ABC" IN 1/2" LETTERS AND DATE CODE IN 1/4" LETTERS.
11. HARDWARE SHOULD BE PACKAGED IN BURLAP BAG AND ATTACHED TO FOUNDATION.

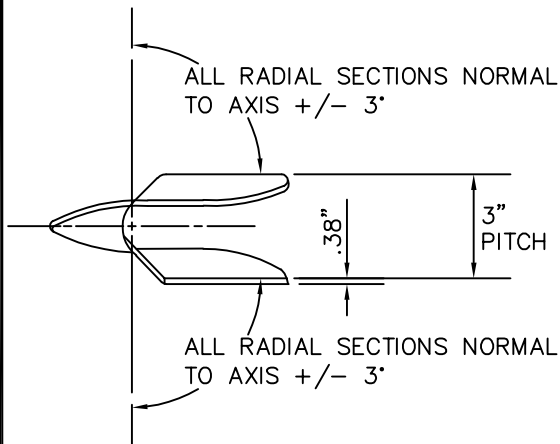

HELIX MUST BE FORMED BY MATCHING METAL DIE  
(SIDE VIEW OF TRUE HELICAL FORM)

RECOMENDED TORQUE: NO GREATER THAN 16,000 FT. LB.



**CITY OF  
CHANHASSEN**

LIGHTING  
ASSEMBLY  
BASE DETAIL

REVISED: 2-08

FILE NAME: G:\ENG\SPecs\5241

ENGINEERING DEPARTMENT

PLATE NO.:

5241